



Model Number:
WGBCX-1880

RF Components

C-Band Waveguide E Plane Bend

3.95-5.85 GHz

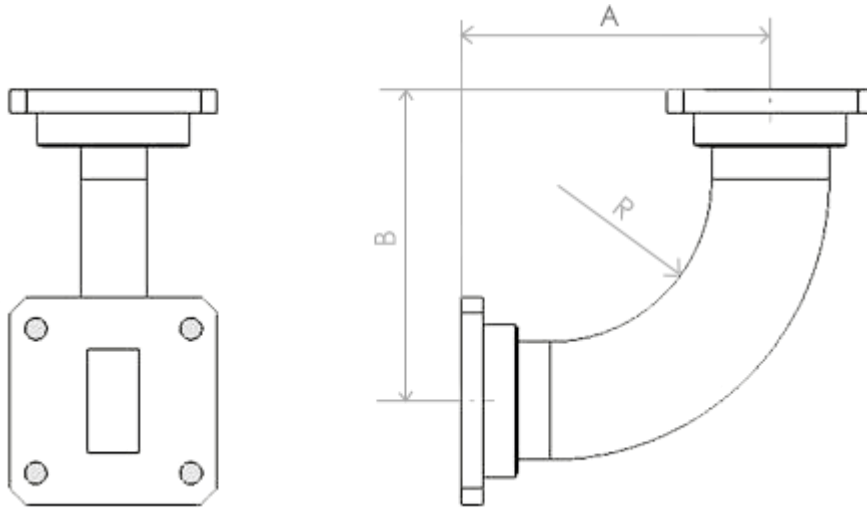

Specification		
WGBCX	1880	1880-A
Waveguide Size	WG12/ WR187 / R48	
Available Flanges (abbreviation)	CPRG48 (CG) / CPRF48 (CF) PDR 48 (PD) / UDR 48 (UD) UG148C/U (UG) / UG148/U (UF) PAR 48 (PA) UAR 48 (UA)	
Flange Material/Finish	Brass Flanges Copper WG Black Paint	Aluminium Flanges Aluminium WG Black Finish
Frequency Range	3.95-5.85 GHz	
VSWR / Return Loss	1.05 / 32.2 dB	
Power	1005 kW - Max	
Dimension A	100 mm	
Dimension B	100 mm	
Bend Angle	90 degrees	
Radius	70 mm	

Broadcast



Marine Oil & Gas



SNG & VSAT



Satellite Teleport

